

THIS SITE IS LOCATED IN THE HEART OF THE BANGKOK, NEAR ONE OF THE BUSIEST INTERSECTIONS AND CHATUCHAK PARK. THE BUS STOP IS CROWDED WITH PEOPLE EITHER COMMUTING BY BUS OR CONNECTING TO BTS SKY TRAIN. AIR POLLUTANTS FROM MOTOR VEHICLES AS WELL AS SECOND HAND SMOKE ARE FOUND IN HIGHER CONCENTRATIONS, CARRIES SIGNIFICANT RISKS FOR HUMAN HEALTH AND THE ENVIRONMENT. HOWEVER, LOCATION ADVANTAGE IS THE LARGE GREEN PARK BEHIND THE BUS STOP PROVIDING GREEN AREAS FOR THE CITY'S INHABITANTS.

**SITE ANALYSIS**



**DESIGN INSPIRATION COMES FROM THE PROBLEMS**

MY INTENTION IS TO DESIGN A BUS STOP WHERE PEOPLE CAN WALKING ALONG OR WAITING IN LINES, RELAX FROM SURROUNDING GREEN SPACE AND ENJOY THE VIEWS, WHILE ALSO PROVIDING PLACE UTILITY FOR PEOPLE BUYING NEWSPAPERS, SNACKS, AND SOFT DRINKS. THE MOST IMPORTANT OF DESIGN IS SETTING UP THE SMOKING ZONE WHICH IS MORE FUNCTIONAL ENVIRONMENT AND FUTURISTIC.

**SMOKING ZONE IS DEVIDED TO 3 FUNCTIONS**

- BUS STOP
- SMOKING ZONE
- SHOP : NEWSSTAND AND COFFEE BAR



**FRONT ELEVATION**





SMOKING



SMOKING



SMOKING AREA



USER + BEHAVIOR = AREA



## DESIGN CONCEPT

THE SMOKING ZONE CONCEPT IS TO DESIGN GREEN SHELTER WITH BUS STOP, SMOKING AREA AND SHOP. SMOKING AREA IS RAISED TO THE MEZZANINE WITH STRONG EMPHASIS PLACED ON THE USE OF NATURAL VENTILATION. WIND CAN BLOW AIR THROUGH OPENINGS IN THE GARDEN WALL, IT CAN HELP IN ELIMINATING CIGARETTE SMOKE AND FOUL ODOR WITHOUT ANNOYING ANY NON-SMOKER. THE PLANTS USED IN GREEN WALLS CAN RETAIN HEAT FROM THE SUN AS WELL AS ABSORB AND CLEAN POLLUTANTS FROM THE AIR; THROUGH PHOTOSYNTHESIS, THEY TAKE IN CARBON DIOXIDE AND RELEASE OXYGEN.



SMOKING AREA  
GREEN AREA CHATUCHAK PARK

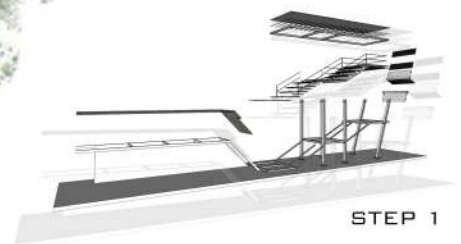

STEP 1

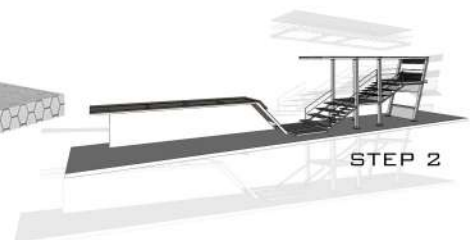

STEP 2

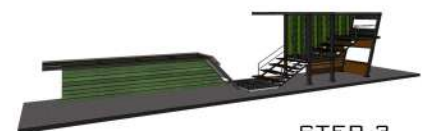

STEP 3

THE SMOKING ZONE IS MUCH MORE MODERN IN STYLE BUT HARMONY WITH SURROUNDING. THIS COMFORTABLE SHELTER FROM THE NATURAL ELEMENTS WITH ENVIRONMENTALLY FRIENDLY FEATURES LIKE ECO-FRIENDLY MATERIALS CONSTRUCTION, RECYCLED MATERIALS, SOLAR PANELS AT ITS ROOF TO HARNESS CLEAN ENERGY TO POWER VARIOUS TYPES OF EQUIPMENT.

## ECO DESIGN

- RENEWABLE ENERGY
- REDUCTION OF LOW-IMPACT MATERIALS
- OPTIMIZATION OF INITIAL LIFETIME
- OPTIMIZATION OF DISTRIBUTION SYSTEM



## GREEN DESIGN

THE SMOKING ZONE COMBINES VERTICAL GARDENS WITH INTERIOR DESIGN. ITS COLOR AND TEXTURE CREATE A GOOD ATMOSPHERE THAT WILL GIVES A FRESH. MAKE PEOPLE RELAX AND FEEL CLOSE TO NATURE.

USER  
+  
BEHAVIOR  
=  
AREA



GARDEN WALL



COFFEE BAR



SMOKING AREA



NEWSSTAND

THE WOOD STAIR IS POSSIBLE TO USE AS SEATS. AT THE TOP OF THE STAIRCASE PROVIDED THE SEAT CUSHIONS OFFER A LEVEL OF COMFORT.



SMOKING AREA



COFFEE BAR



SHOP IS INTEGRATED WITH NEWSSTANDS, SOFTDRINK, COFFEE BAR AND SNACK FOR ALL COMMUTERS AND PEDESTRIANS. USING RECYCLED WOOD AND STEEL FOR DESIGN FEATURE WHICH IS HARMONY WITH NATURE.



COLOUR SCHEME

THIS PROJECT FOCUS ON NATURAL COLOR, GREEN, GREY, ORANGE-BROWN  
PRESENTING APPROPRIATE CONTEXT SURROUNDING.

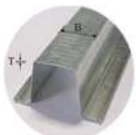

PURLINS HOT DIP GALVANIZED  
0.55x65MMx3.00M

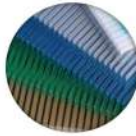

POLYCARBONATE ROOFING



FLAT BARS STEEL



EXPANDED METAL



I-BEAM STEEL  
I = 150x150x7x9MM.x3.00M

SOLAR CELL

H-BEAM STEEL

CHECKERED PLATES

WOOD PALLETS

DETAIL

**GARDEN WALL** TREES ARE PLANTED IN THE GARDEN WALL TO ABSORB THE SMOKE IS THE SUBJECT OF TOXINS POLLUTION AS WELL  
DETAIL VERTICAL GARDEN

